

City of Surrey Sport & Leisure Complex

16555 Fraser Highway, Surrey, British Columbia, CANADA



ICE COMPLEX



Sport & Leisure Complex

THE PROJECT

Mitchell Kime Thompson (MKT) continued its successful relationship with the City of Surrey with the development of the Surrey Ice Complex. Connecting to the Aquatic Centre, the Ice Complex consists of two NHL sized ice surfaces, a mezzanine for future retail opportunities overlooking both the ice surfaces and the Aquatic Centre pools, 8 team dressing rooms and a two storey glass atrium entrance lobby. The project was completed on schedule and opened in October 1999. The Guaranteed Maximum Price was under \$7 Million including all F.F. & E.

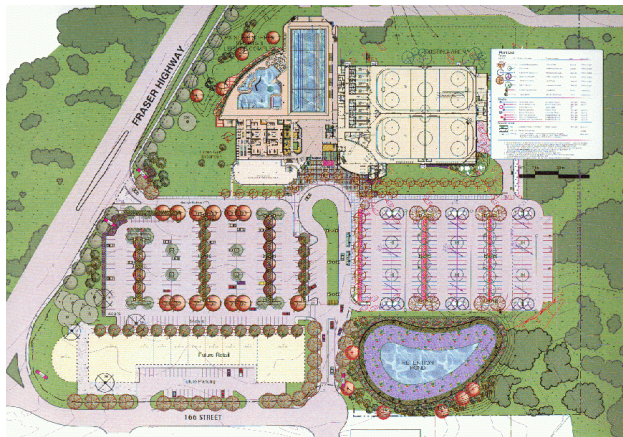

Site Plan

THE TASK

To deliver an aesthetically pleasing and cost effective ice complex including all furnishings and fixtures.

THE RESULT

The project commenced in March 1999 and opened on October 22nd, 1999, on schedule and under the GMP.

MKT

Project Managers
Development Managers
Development Consultants

Design-Build Contractor: Mitchell Kime Thompson Inc.
Architect: DGBK Architects
Contractor: D&T/WVI Construction Ltd.

#1460 - 1188 West Georgia Street
Vancouver, B.C., Canada V6E 4A2
Tel 604-669-9400 Fax 604-669-9410
www.mkt.ca mktinc@axion.net